

**This electronic collection of documents is provided
for the convenience of the user
and is Not a Certified Document –**

**The documents contained herein were originally issued
and sealed by the individuals whose names and license
numbers appear on each page, on the dates appearing
with their signature on that page.**

**This file or an individual page
shall not be considered a certified document.**

STATE OF NORTH CAROLINA DIVISION OF HIGHWAYS

STATE	STATE PROJECT REFERENCE NO.	SHEET NO.	TOTAL SHEETS
N.C.	36053.045	1	

TIP PROJECT: 36053.045

CONTRACT: DNI1645066



LOCATION: *Haywood Knolls Subdivision – NC 191 at SR2044 (Haywood Knolls Drive)
Hendersonville, Henderson County, North Carolina*

TYPE OF WORK: *Subdivision Snow and Ice Removal*

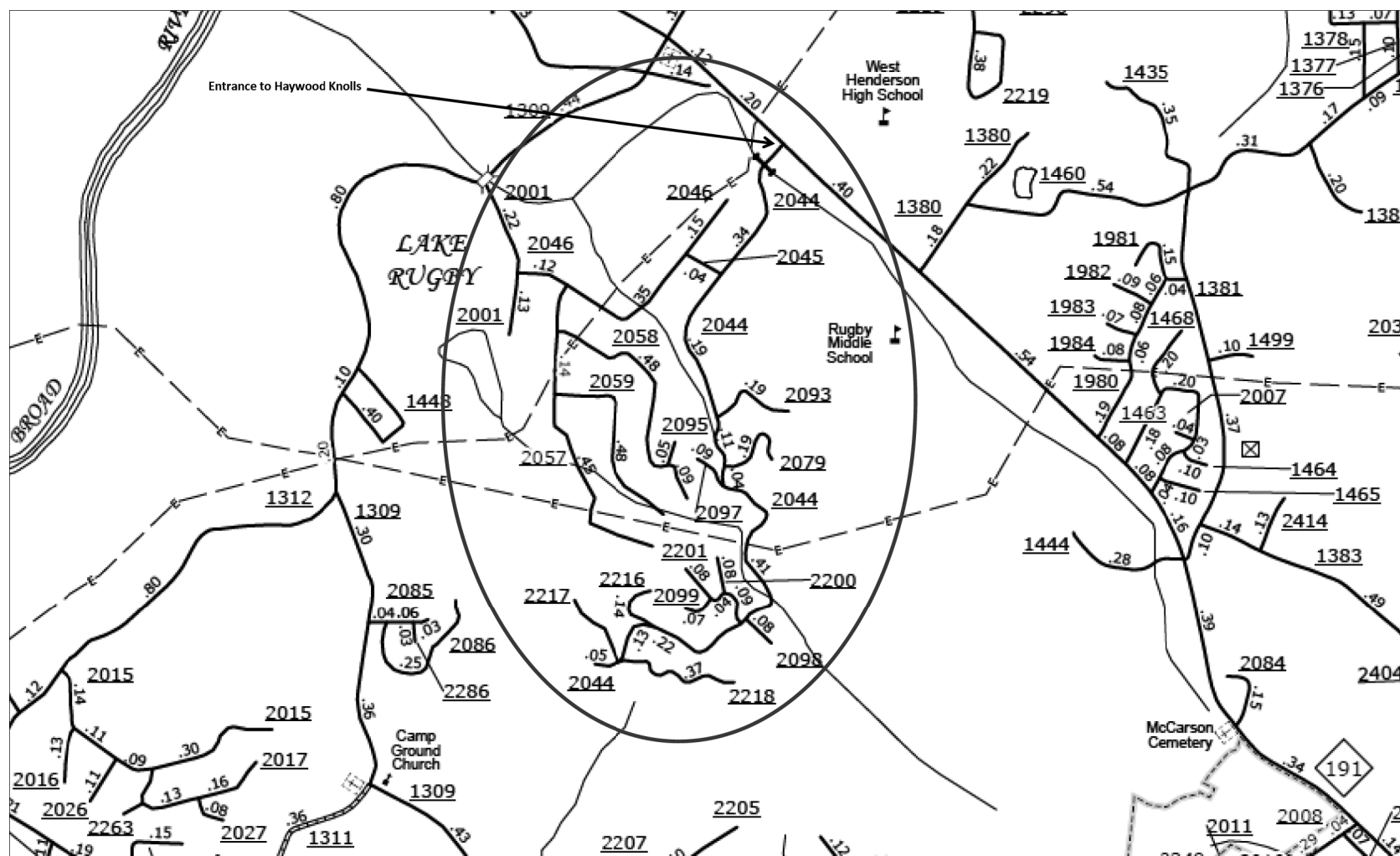

The ending project limits for each subdivision are the ends of each of the state maintained subdivision roads as shown on this overall vicinity map. The length of each subdivision road is listed on the Detail of Subdivision Routes plan sheet.

\$\$\$\$\$ SYSTEM \$\$\$\$\$
\$\$\$\$\$ DGN \$\$\$\$\$
\$\$\$\$\$ USERNAME \$\$\$\$\$

PROJECT LENGTH

Haywood Knolls = 5.97 miles

Prepared In the Office of:
DIVISION OF HIGHWAYS
1000 Birch Ridge Dr., Raleigh NC, 27610

2012 STANDARD SPECIFICATIONS

RIGHT OF WAY DATE: *S.L. Cannon, PE*
PROJECT ENGINEER

LETTING DATE: *R.C. Chambard*
PROJECT DESIGN ENGINEER

HYDRAULICS ENGINEER

SIGNATURE: _____ P.E.

ROADWAY DESIGN ENGINEER

SIGNATURE: _____ P.E.

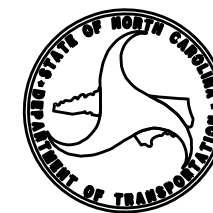

INDEX OF SHEETS

SHEET NUMBER:

SHEET TITLE:

<i>1</i>	<i>TITLE SHEET</i>
<i>1A</i>	<i>INDEX OF SHEETS</i>
<i>4</i>	<i>SUBDIVISION ROUTE MILEAGE SUMMARY SHEET – HAYWOOD KNOLLS</i>
<i>4A</i>	<i>AERIAL VIEW SUBDIVISION SHEET – HAYWOOD KNOLLS</i>
<i>4B</i>	<i>DETAIL OF SUBDIVISION ROUTE SHEET – HAYWOOD KNOLLS</i>

8/17/99

UNIVERSITY OF CALIFORNIA
LIBRARY

AERIAL VIEW SUBDIVISION SHEET - HAYWOOD KNOLLS - DN11645066

8/17/99

REVISIONS

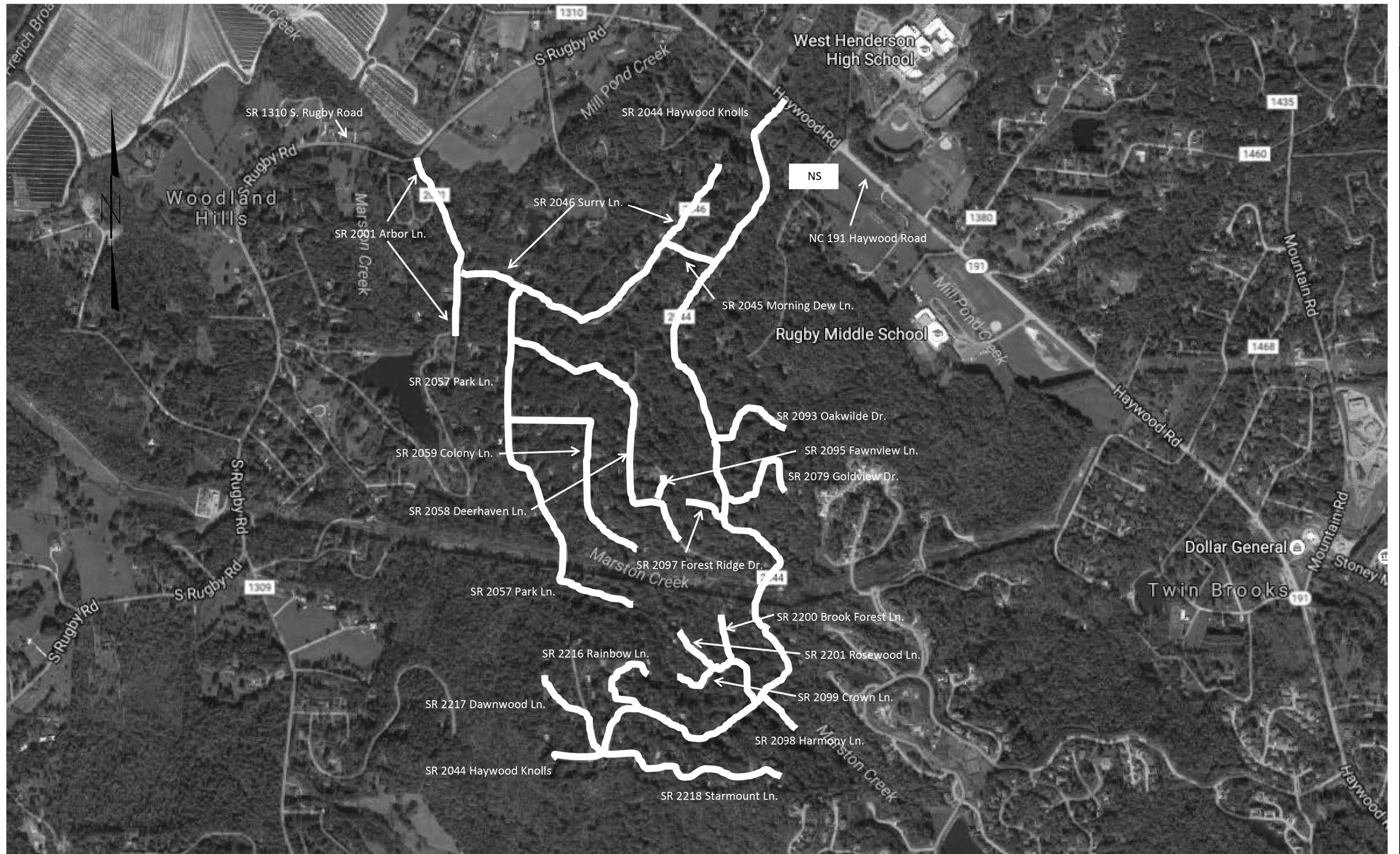

C:\Users\jason\Documents\Projects\Haywood Knolls\Aerial View Subdivision Sheet.dwg
 8/17/99
 JASON
 USER

